

SHIMANO®

MAGNUMLITE® GT-X1100 PLUS

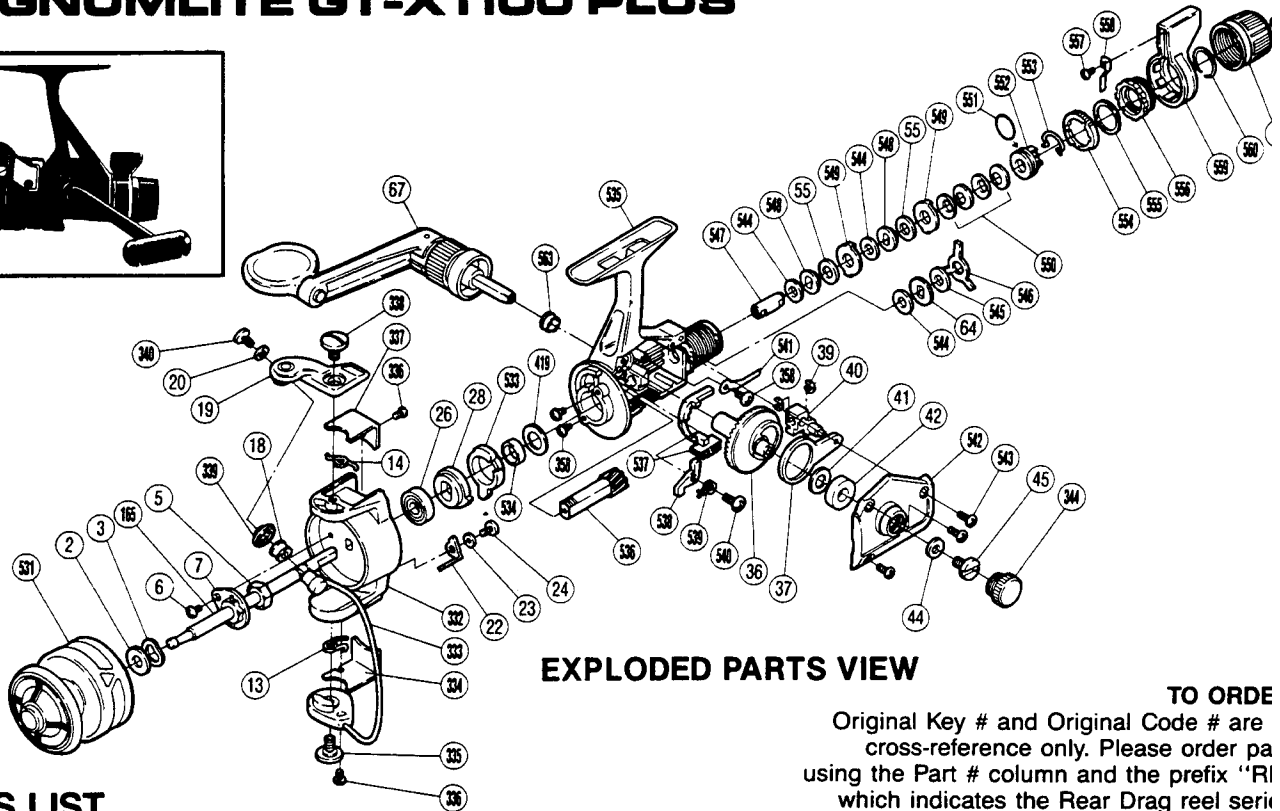
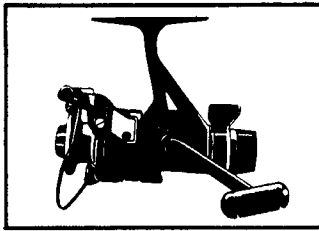

EXPLODED PARTS VIEW

TO ORDE

Original Key # and Original Code # are cross-reference only. Please order pa using the Part # column and the prefix "RI" which indicates the Rear Drag reel seri

PARTS LIST

PART #	ORIGINAL KEY #	ORIGINAL CODE #	DESCRIPTION	PART #	ORIGINAL KEY #	ORIGINAL CODE #	DESCRIPTION
531.	1.	6-0209 31211S	Spool Assembly	37.	38.	7-0410 26100S	Oscillating Arm
2.	2.	7-0217 26100S	Spool Washer	44.	39.	7-0725 05500S	Handle Lock Washer
3.	3.	7-2101 06100S	Tension Spring	541.	40.	7-0122 32100S	Drag Click
6.	4.	7-0013 30410S	Nut Lock Screw	358.	41.	7-0014 30220S	Drag Click Screw
165.	5.	6-0219 27101S	Main Shaft Assembly	39.	42.	7-0525 26100S	"C" Lock
7.	6.	7-0360 21000S	Rotor Nut Lock Plate	40.	43.	7-0472 26100S	Oscillating Block
5.	7.	7-0311 26100S	Rotor Nut	41.	44.	7-0446 01100S	Drive Gear Washer
339.	8.	7-0423 29120S	Line Roller Washer	42.	45.	7-0617 26100S	Drive Gear Bushing A
18.	9.	7-0304 21100S	Line Roller	542.	46.	6-0609 32100S	Side Cover
332.	10.	7-0301 29120S	Rotor	543.	47.	7-0011 30710S	Side Cover Screw
333.	11.	6-0309 29120S	Bail	45.	48.	7-0710 05100S	Handle Lock Screw
334.	12.	7-0338 29120S	Bail Trip Cover	344.	49.	7-0453 26120S	Handle Screw Cap
335.	13.	7-0335 29120S	Bail Trip Cam Screw	544.	50.	7-0139 26110S	Drag Washer "C ₂ "
336.	14.	7-0013 30113S	Cover Screw	64.	51.	7-0113 26100S	Click Gear
13.	15.	7-0337 19300S	Lever Spring	545.	52.	7-0139 26101S	Drag Washer "C ₃ "
14.	16.	7-0310 24500S	Bail Spring	546.	53.	7-0159 32100S	Eared Washer "BF"
337.	17.	7-0307 29120S	Bail Spring Cover	547.	54.	7-0112 32100S	Drag Shaft
338.	18.	7-0306 29120S	Bail Arm Screw	548.	55.	7-0115 32100S	Key Washer "A"
340.	19.	7-0013 00920S	Line Roller Screw	55.	56.	7-0139 26100S	Drag Washer "C ₁ "
20.	20.	7-0316 21100S	Lock Washer	549.	57.	7-0116 32100S	Eared Washer "B"
19.	21.	7-0303 21000S	Bail Arm	550.	58.	7-0145 32100S	Coned Disc Springs
22.	22.	7-0336 24500S	Bail Trip Lever	551.	59.	7-0160 32100S	"O" Ring
23.	23.	7-0354 19300S	Trip Lever Spacer	552.	60.	7-0110 32100S	Pressure Screw
24.	24.	7-0014 30210S	Trip Lever Screw	553.	61.	7-0149 32100S	Hold Click Spring
26.	25.	7-0402 19300S	Ball Bearing	554.	62.	7-0155 32100S	Lever Click Gear
28.	26.	7-0421 21000S	Anti-Reverse Ratchet	555.	63.	7-0157 32100S	Fightin' Pressure Screw Washer
533.	27.	7-0522 32100S	Anti-Reverse Lock Out	556.	64.	7-0156 32100S	Fightin' Pressure Screw
534.	28.	7-0428 32100S	Pinion Spacer	557.	65.	7-0010 00110S	Fightin' Drag Click Screw
419.	29.	7-0514 28110S	Bushing Washer	558.	66.	7-0154 32100S	Fightin' Drag Click
358.	30.	7-0011 30470S	Bearing Retainer Screw	559.	67.	6-0441 32100S	Fightin' Drag Lever
535.	31.	6-0409 32100S	Body	560.	68.	7-0158 32100S	Lever Hold Spring
536.	32.	7-0407 32100S	Pinion Gear	561.	69.	6-0439 30110S	Drag Programmer
537.	33.	7-0404 32100S	Anti-Reverse Switch	562.	70.	7-0013 40620S	Drag Programmer Screw
538.	34.	7-0427 32100S	Anti-Reverse Pawl	67.	71.	6-0709 27100S	Handle Assembly
539.	35.	7-0422 24500S	Anti-Reverse Pawl Spring	563.	72.	7-0430 29050S	Drive Gear Bushing B
540.	36.	7-0013 30140S	Anti-Reverse Pawl Screw				
36.	37.	7-0408 26100S	Drive Gear				